

310420-SM-CC-EC-VV

NOTES:

1. PILOT PRESSURE TO MEDIA PRESSURE RATIO: 1:1.
2. OPERATING PRESSURE: 150 PSI MAX.
3. TEMPERATURE RANGE: -30° F TO 225° F.
4. PRIMARY OPERATOR: DIRECT SOLENOID OPERATOR.
5. SERVICE MEDIA: LIQUIDS AND INERT GASES.
6. SLEEVE MATERIAL: SEE TABLE SLEEVE MAT. OPTIONS (SM) FOR ALL OTHERS CONSULT THE FACTORY.
7. SOLENOID VOLTAGE: AC OR DC
8. FOR MAXIMUM SLEEVE LIFE, THE PILOT TO MEDIA PRESSURE DIFFERENTIAL, SHOULD NOT EXCEED 20 PSI. FOR MEDIA PRESSURE BELOW 50 PSI, THE PILOT PRESSURE IS MEDIA PRESSURE PLUS 15 PSI.

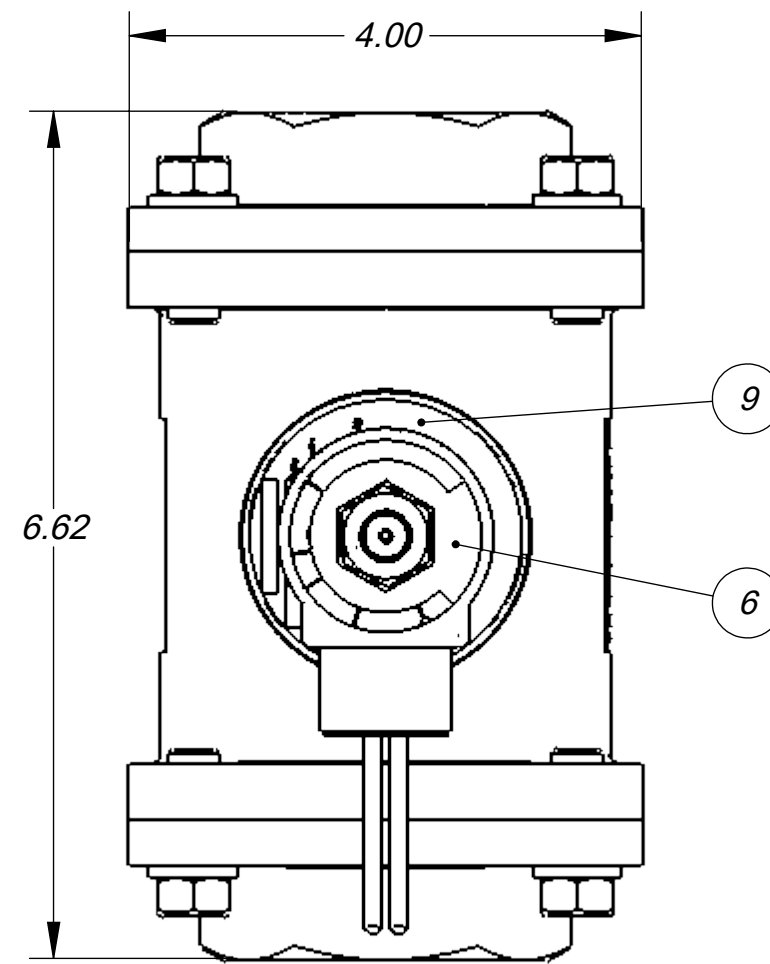

ITEM NO.	PART NUMBER	DESCRIPTION	QTY.
1	01-0151	SCR., 3/8-16 X 1.00, HEX HD. CAP, ZN	8
2	01-0200	WASHER, LOCK, 3/8 REGULAR ZINC	8
3	01-2023-2	SCREW, RIVET, #2 X .188, SS	2
4	03-1179	BODY, P/P SOL. ADAPTOR	1
5	03-1180	EXHAUST ADAPTOR	1
6	03-4001	NAMEPLATE, SERIES 20 SOL. OPP.	1
7	04-01-010	O-RING, BUNA 70, #010	1
8	20-1708	BODY, 1 1/4, 1 1/2 NPT T-O-M	1
9	20-1890	NAME PLATE, 1 1/4 -2 1/2 NPT, T-O-M	1
10	SEE TBL (CC)	CENTER CORE	1
11	SEE TBL (EC)	END CAP 1 1/4	2
12	SEE TBL (SM)	SLEEVE	1
13	SEE TBL (VV)	SOLENOID ASSY	1

SLEEVE MATERIAL OPTIONS (SM)

CODE	MATERIAL	PART NO.
STD	BUNA - N	20-1112
26	VITON	20-1113
29	EPR	20-1114

CENTER CORE MATERIAL (CC)

CODE	MATERIAL	PART NO.
STD	NI PLT BRASS	20-1141

END CAP OPTIONS (EC)

CODE	MATERIAL	PART NO.
STD	NI PLT BRNZE	20-1121

SOLENOID OPTIONS (VV)

CODE	VOLTAGE	PART NO.
-1	120V/60Hz	03-3701
-2	240V/60Hz	03-3702
-3	480V/60Hz	03-3703
-4	6V DC	03-3704
-5	12V DC	03-3705
-6	24V DC	03-3706
-7	24V/60Hz	03-3707

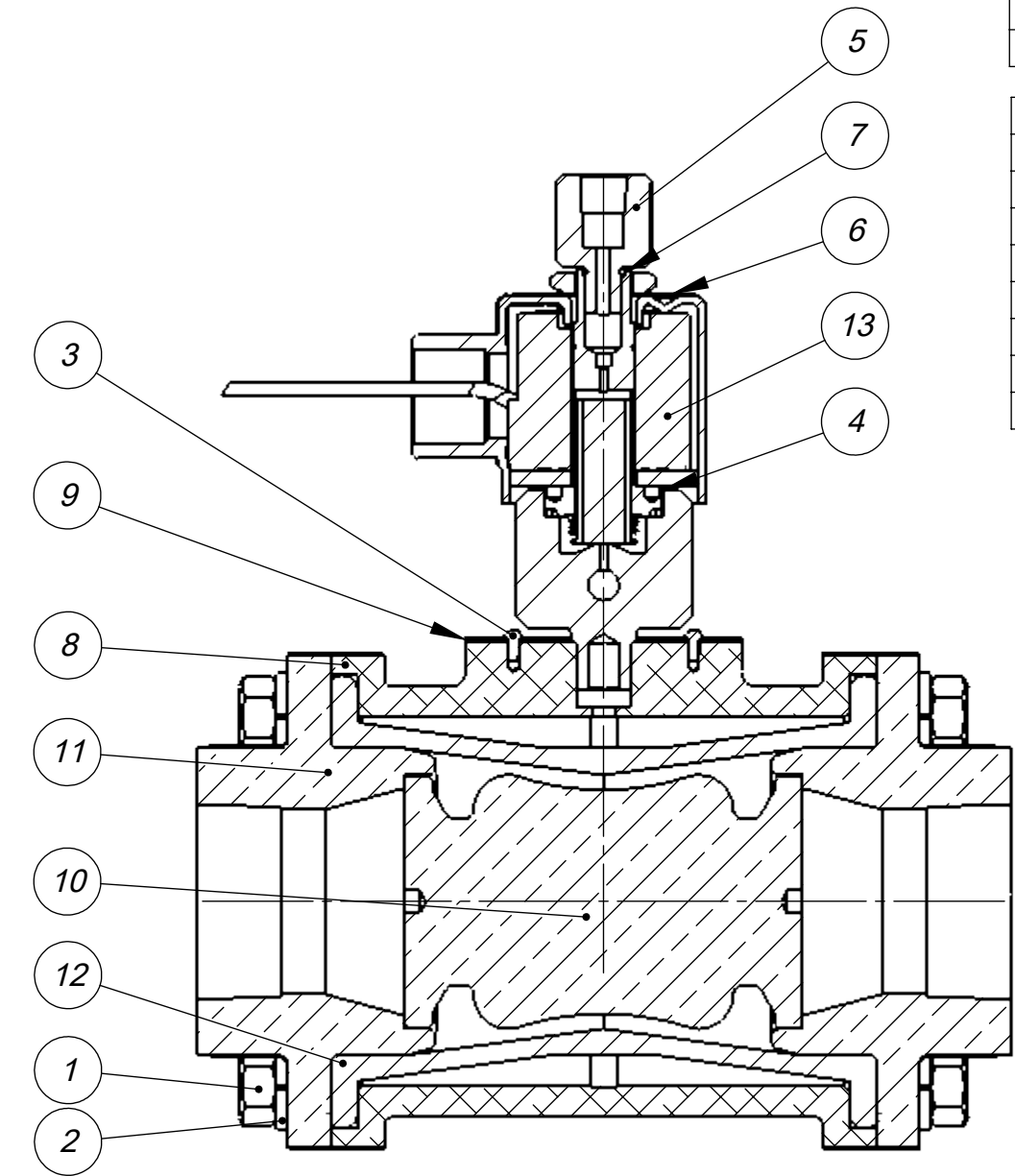
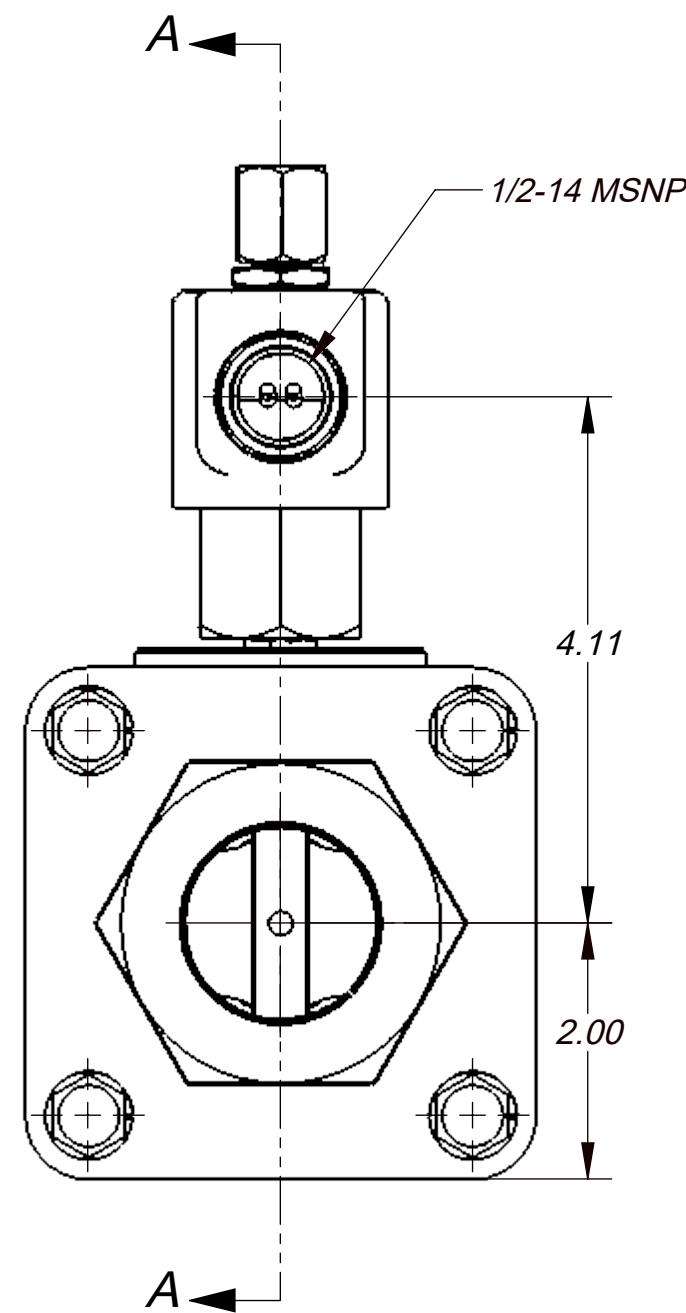
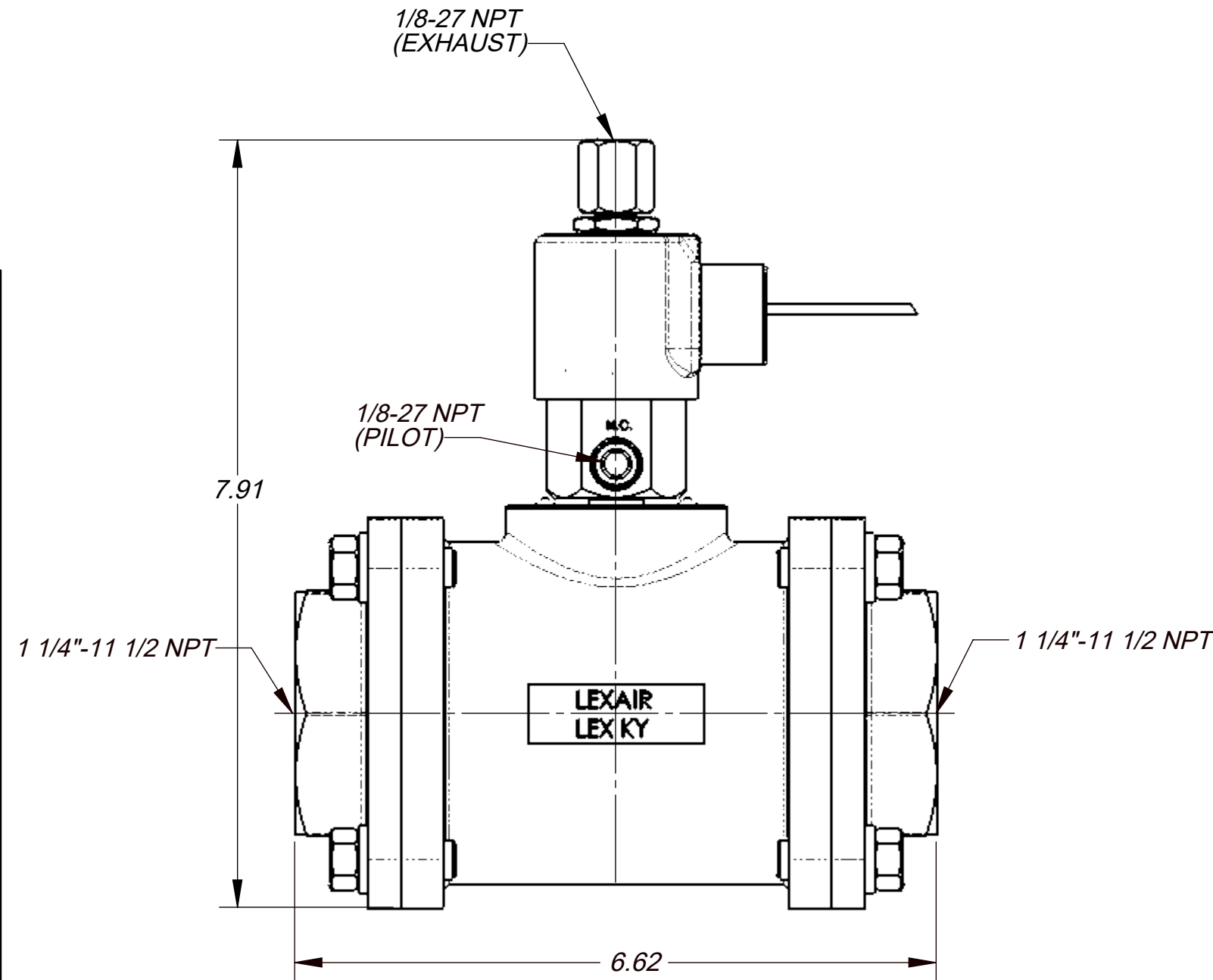

SECTION A-A  
SCALE 1 : 1.5

THIS DOCUMENT AND ITS CONTENTS ARE THE PROPERTY OF LEXAIR, INC. THEY ARE FURNISHED TO YOU ON THE FOLLOWING CONDITIONS: NO RIGHT OR LICENSE IN RESPECT OF THIS DOCUMENT OR ITS CONTENTS IS GIVEN OR WANTED IN SUPPLYING THE DOCUMENT TO YOU. THIS DOCUMENT OR ITS CONTENTS ARE NOT TO BE USED OR TREATED IN ANY MANNER INCONSISTENT WITH THE RIGHTS OF LEXAIR, INC. OR TO ITS DETRIMENT AND ARE NOT TO BE COPIED, REPRODUCED, OR DISCLOSED OF, EXCEPT WITH ITS PRIOR WRITTEN CONSENT.

REVISIONS

- A** REDRAWN TO CURRENT ENG. STDS. ECL: 06/13 10-16-06 HWP TPO
- B** REDRAWN TO CURRENT ENG. STDS. ECL: 21032 06-22-21 TES

Tolerances Unless Otherwise Specified:

TYPE	FINISHED	AS CAST
DEC .00	± .015"	± .030"
DEC .000	± .005"	± .010"
FRACTIONAL	± 1/64"	± 1/32"
ANGLES *	± 1/2°	± 1°

FINISH 175 µ in.

MATERIAL SPEC.	SEE TABLE
PROCESS SPEC.	SEE TABLE

PC. NO.:	310420-X
MADE FROM:	
MODEL FILE:	310420.SLDASM
CAD FILE:	310420.slddrw

**SO, T-O-M, 1 1/4" NPT**

**Lexair, Inc.**

2025 Mercer RD, Lexington, Kentucky 40511

DRAWN	CHECKED	APRVD.	SHEET NO.	1 of 1	SHEETS
HWP	TPO	TPO	SCALE	1:1.5	
10-16-06	10-16-06	10-16-06	APPROX. WT.	11.569 lbs.	